

- CIVIL CONSTRUCTION NOTES:**
1. COMPLY WITH ALL GOVERNING REQUIREMENTS OF CEC, PART 1, 23RD EDITION, CAN/CSA - C22.3 #7-10 AND C22.2 #52-09, C22.2 #211.1-06, C22.2 #211.2 -06.
 2. PERFORM DETAILED SITE INVESTIGATION PRIOR TO CONSTRUCTION. IF DISCOVERED THAT SITE CONDITIONS DO NOT ALLOW TO FOLLOW THE ORIGINAL DESIGN - ELECTRICAL DESIGN SHALL BE NOTIFIED IMMEDIATELY. ANY CHANGES TO THE ORIGINAL DESIGN SHALL BE REVIEWED AND APPROVED BY ELECTRICAL DESIGN.
 3. PHOTO DOCUMENT ALL EQUIPMENT INSTALLATION BEFORE BACKFILLING AND SUBMIT TO ELECTRICAL DESIGN.
 4. TEMPORARY SUPPORT, ADEQUATE PROTECTION, AND MAINTENANCE OF ALL UNDERGROUND AND SURFACE UTILITIES STRUCTURES, DRAINS, SEWERS, AND OTHER OBSTRUCTIONS ENCOUNTERED IN THE PROGRESS OF THE WORK SHALL BE PROVIDED BY ELECTRICAL OPS.
 5. ALL JUNCTION BOXES SHALL BE CITY APPROVED, TIER 22 RATED, SIZE AS SPECIFIED ON DRAWING.
 6. LOCATION OF EXISTING JUNCTION BOXES ARE DIAGRAMMATIC ONLY. ALL NEW JUNCTION BOXES SHALL BE LOCATED IN BOULEVARD AREAS (MAY BE ADJUSTED TO SUIT FIELD CONDITIONS IN CONSULTATION WITH ELECTRICAL DESIGN). ALL CHANGES SHALL BE RECORDED ON AS-BUILT DRAWINGS.
 7. INSTALLATION OF JUNCTION BOXES TO BE AS PER MANUFACTURER'S INSTALLATION MANUAL.
 8. ALL OFFSETS INDICATE CENTERLINE OF COV DUCTS BANK.
 9. ROUTING OF EXISTING CONDUIT(S) IS DIAGRAMMATIC ONLY, OTHERWISE AS NOTED. ROUTING OF PROPOSED CONDUIT(S) MAY BE ADJUSTED TO SUIT FIELD CONDITIONS IN CONSULTATION WITH ELECTRICAL DESIGN.
 10. COV DUCT CLEARANCES TO OTHER UTILITIES SHALL BE AS PER COV UTILITIES DESIGN & CONSTRUCTION MANUAL. EXCEPTIONS WILL BE CONSIDERED BY ELECTRICAL DESIGN.
 11. TOTAL NUMBER OF BENDS SHALL NOT EXCEED A COMPOSITE ANGLE OF 360 DEGREES. ALL CONDUIT BENDS SHALL BE FACTORY MADE ONLY, NO FIELD BENDS WILL BE ACCEPTED.
 12. CONDUITS SHALL HAVE A MINIMUM OF 600 MM OF COVER AND INSTALLED AS PER SPECIFIED DUCT CONFIGURATION/TRENCH DETAILS.
 13. AN APPROVED "BURIED CABLE" MARKER TAPE SHALL BE INSTALLED IN ALL TRENCHES.
 14. CLEARANCE FROM TREE TRUNK SHALL BE AS SPECIFIED BY PARK OPS AND SHALL BE MINIMUM 305mm CLEARANCE FROM TREE TRUNK.
 15. DUCT ENTERING TO JUNCTION BOX SHALL BE THRU OPEN BOTTOM EXCEPT FOR COMM JB & VAULT 243.
 16. DUCT IN JUNCTION BOX SHALL BE C/W BELL END.
 17. STUBBED-OFF DUCTS AND EMPTY DUCTS IN JUNCTION BOX SHALL BE CAPPED.
 18. OTHER UTILITIES SHOWN ON DRAWING ARE FOR REFERENCE ONLY. PROVE LOCATION OF ALL UTILITIES IN THE WORK AREA BEFORE CONSTRUCTION. FOR CURRENT INFORMATION CONTACT BC ONE CALL.
 19. ALL DISTURBED AREAS SHALL BE RESTORED TO THE CONDITIONS PRIOR TO GROUND DISTURBANCE.

NOT FOR CONSTRUCTION

ISSUED FOR INFORMATION

ALL EMPTY CONDUIT TO BE CAPPED AND EQUIPPED WITH 6mm NYLON PULLSTRING

CITY OF VANCOUVER
 * GAS PRESSURE OVER 100 P.S.I.
 BEFORE CROSSING OR CONSTRUCTING
 WITHIN 2.0 METERS OF PIPELINE
 APPLY TO FORTIS BC GAS

FOR CITY/CONTRACTOR SCOPE ON TRAFFIC SIGNAL AND STREET LIGHTING PROJECTS REFER TO TRAFFIC SIGNAL SCOPE AND RESPONSIBILITIES MATRIX

CHECK BEFORE YOU DIG
 CONTRACTOR SHALL REFER TO MUNICIPAL RECORD/CIVIL DESIGN DRAWINGS FOR ALL OTHER UTILITIES, SERVICE LOCATIONS, AND DETAILS. THE EXACT LOCATION OF THESE UTILITIES SHALL BE DETERMINED ON SITE BY THE CONTRACTOR. CONTACT BC ONE CALL, CALL BEFORE YOU DIG AT 1-800-474-6886. CALL AT LEAST 3 FULL WORKING DAYS BEFORE YOU PLAN TO DIG.

EXISTING STREET LIGHTING SHALL REMAIN IN OPERATION THROUGHOUT CONSTRUCTION. IF TRAFFIC SIGNAL DE-ENERGIZATION IS REQUIRED, CONTRACTOR SHALL ENSURE FULL-TIME FLAGGING IS USED DURING ANY TRAFFIC SIGNAL DOWNTIME.

COORDINATE WITH CITY OF VANCOUVER 15 BUSINESS DAYS IN ADVANCE FOR ANY DISCONNECTION / RECONNECTION OF EXISTING COV INFRASTRUCTURE

CONTACT VIA COV PROJECT MANAGER/PROJECT COORDINATOR (TBD)@VANCOUVER.CA

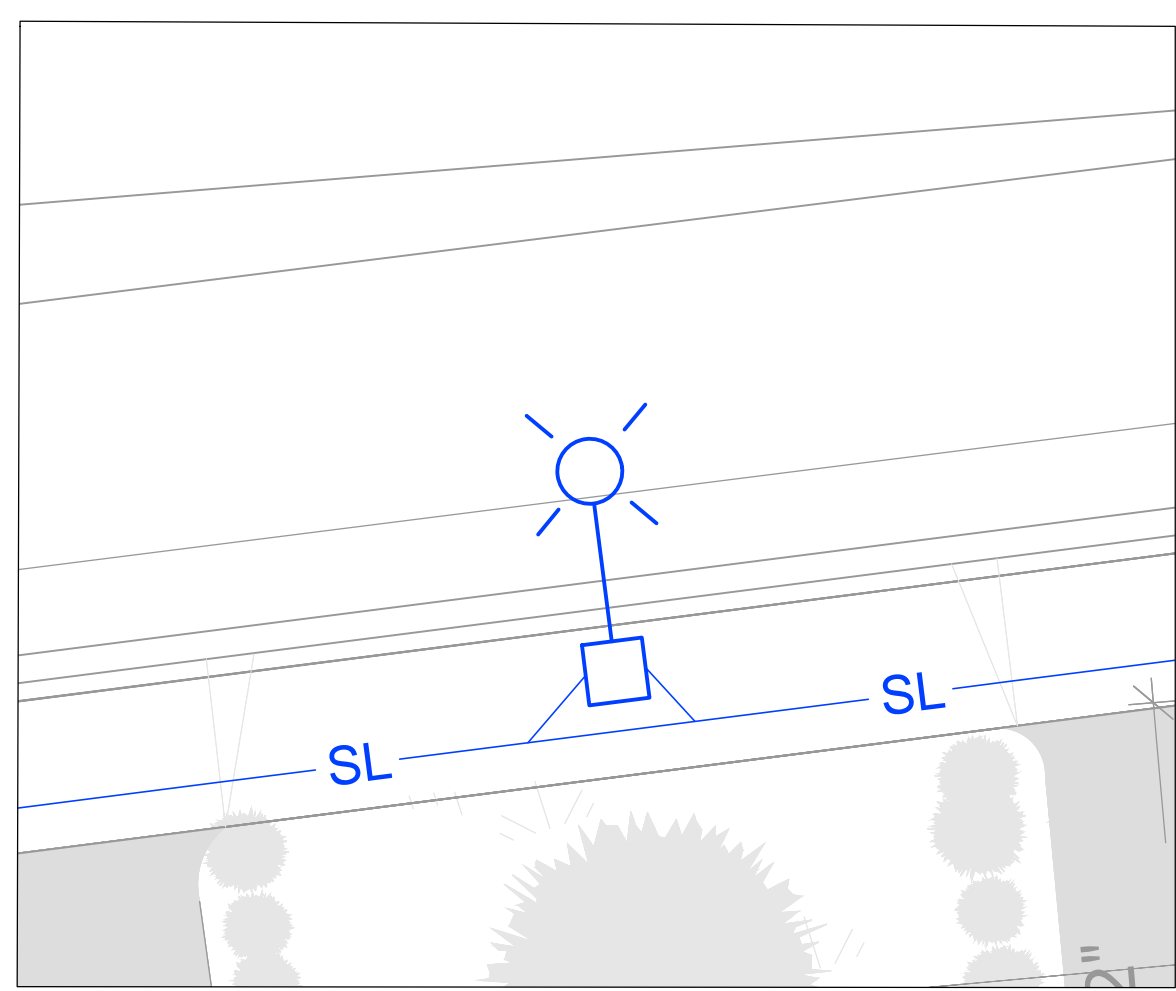

1 1
 POLE & LUMINAIRE DETAIL
 N.T.S.

LEGEND:

| | EXISTING | PROPOSED |
|--|----------------|----------------|
| TRAFFIC SIGNAL DUCT | TS TS | TS TS |
| STREET LIGHTING DUCT | SL | SL |
| COMMUNICATION DUCT | COMM | COMM |
| STUB-OUT | () | () |
| STREET LIGHTING POLE/SHAFT | () | () |
| ROADWAY LUMINAIRE WITH ARM | () | () |
| PEDESTRIAN LUMINAIRE WITH ARM | () | () |
| ROADWAY LUMINAIRE | () | () |
| PEDESTRIAN LUMINAIRE | () | () |
| STREET LIGHTING POLE BLOCK NUMBER | 1 50 | 1 50 |
| JUNCTION BOX TYPE#3 JB (0.279x0.467m) | JB3 | JB3 |
| JUNCTION BOX TYPE#4 JB (0.330 x 0.610M) | JB4 | JB4 |
| JUNCTION BOX TYPE#5 JB (0.432 x 0.762m) | JB5 | JB5 |
| JUNCTION BOX TYPE #6 JB (0.609 x 0.914m) | JB6 | JB6 |
| JUNCTION BOX (COMM) TYPE #62 JB (0.609x0.914x1.219m) | COMM 62 | COMM 62 |
| COMMUNICATION VAULT | COMM VAULT 243 | COMM VAULT 243 |
| EXISTING DEVICE (JB) TO BE REMOVED | 6 | |
| ELECTRICAL PANEL | | |
| LED PEDESTRIAN (4.3m-LED) ON A TYPE B-CONCRETE BASE. | | |
| 2'x4'x3' PAD MOUNTED KIOSK/CABINET | | |
| ELECTRICAL SCOPE OF WORK | | |
| CIVIL SCOPE OF WORK | | |
| SCOPE OF WORK NOTE | | |

| | | | | |
|--------------------------------|----------------------------------|---|--|---|
| | | ELECTRICAL ENGINEER SEAL TRAFFIC ENGINEER SEAL | ATTENTION UNITS SHOWN ON THIS PLAN ARE IN METRES CSA S250 ACCURACY NAD85-10UTM BASE ACCURACY LEVEL: 4+/-1000MM ASB ACCURACY LEVEL: 4+/-1000MM | NEMETZ (S/A) & ASSOCIATES STREET LIGHTING DESIGN CIVIL DESIGN OLIVER'S LANDING AT FURRY CREEK FINE PEACE |
| A REV. NO. DATE (YY.MON.DD) | 2024-SEP-10 ISSUED FOR REVIEW | KZ MV MV | PERMIT TO PRACTICE NO. 1003450 | PROJECT NUMBER 15330 SCALE: AS NOTED SHEET 1 OF 3 REV 0 |
| DESCRIPTION | | DRAWN DESIGN ENG. CHECK REFERENCE DRAWINGS | | |

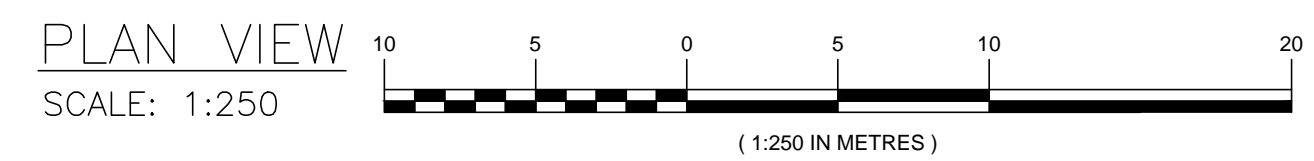
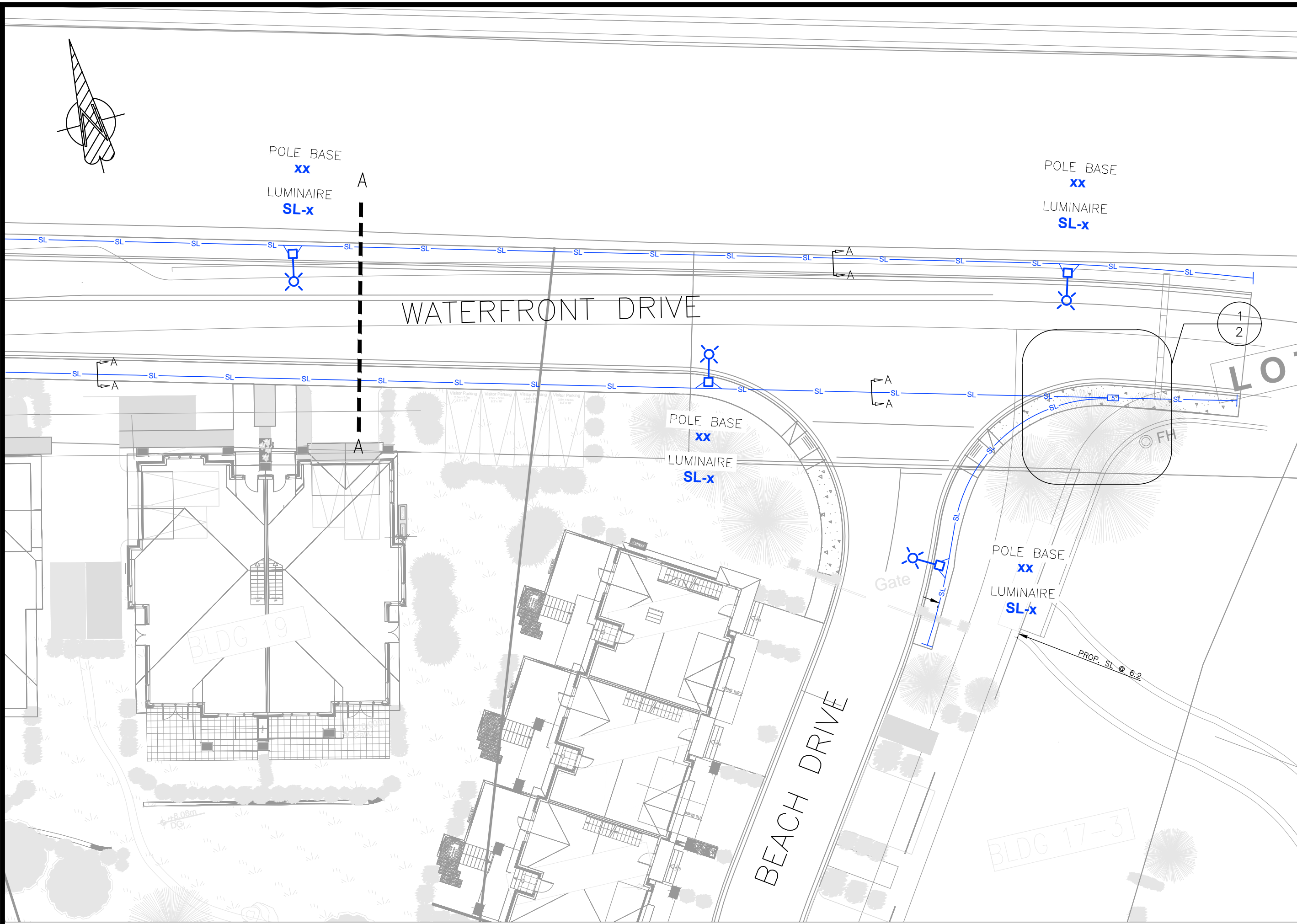

PLAN VIEW
SCALE: 1:250

NOT FOR CONSTRUCTION

ISSUED FOR INFORMATION

ALL EMPTY CONDUIT TO BE CAPPED AND EQUIPPED WITH 6mm NYLON PULLSTRING

CITY OF VANCOUVER
* GAS PRESSURE OVER 100 P.S.I. BEFORE CROSSING OR CONSTRUCTING WITHIN 2.0 METERS OF PIPELINE APPLY TO FORTIS BC GAS

FOR CITY/CONTRACTOR SCOPE ON TRAFFIC SIGNAL AND STREET LIGHTING PROJECTS REFER TO TRAFFIC SIGNAL SCOPE AND RESPONSIBILITIES MATRIX

CHECK BEFORE YOU DIG
CONTRACTOR SHALL REFER TO MUNICIPAL RECORD/CIVIL DESIGN DRAWINGS FOR ALL OTHER UTILITIES, SERVICE LOCATIONS, AND DETAILS. THE EXACT LOCATION OF THESE UTILITIES SHALL BE DETERMINED ON SITE BY THE CONTRACTOR. CONTACT BC ONE CALL CALL BEFORE YOU DIG AT 1-800-474-6886. CALL AT LEAST 3 FULL WORKING DAYS BEFORE YOU PLAN TO DIG.

EXISTING STREET LIGHTING SHALL REMAIN IN OPERATION THROUGHOUT CONSTRUCTION. IF TRAFFIC SIGNAL DE-ENERGIZATION IS REQUIRED, CONTRACTOR SHALL ENSURE FULL-TIME FLAGGING IS USED DURING ANY TRAFFIC SIGNAL DOWNTIME.

COORDINATE WITH CITY OF VANCOUVER 15 BUSINESS DAYS IN ADVANCE FOR ANY DISCONNECTION / RECONNECTION OF EXISTING COV INFRASTRUCTURE

CONTACT VIA COV PROJECT MANAGER/PROJECT COORDINATOR (TBD)@VANCOUVER.CA

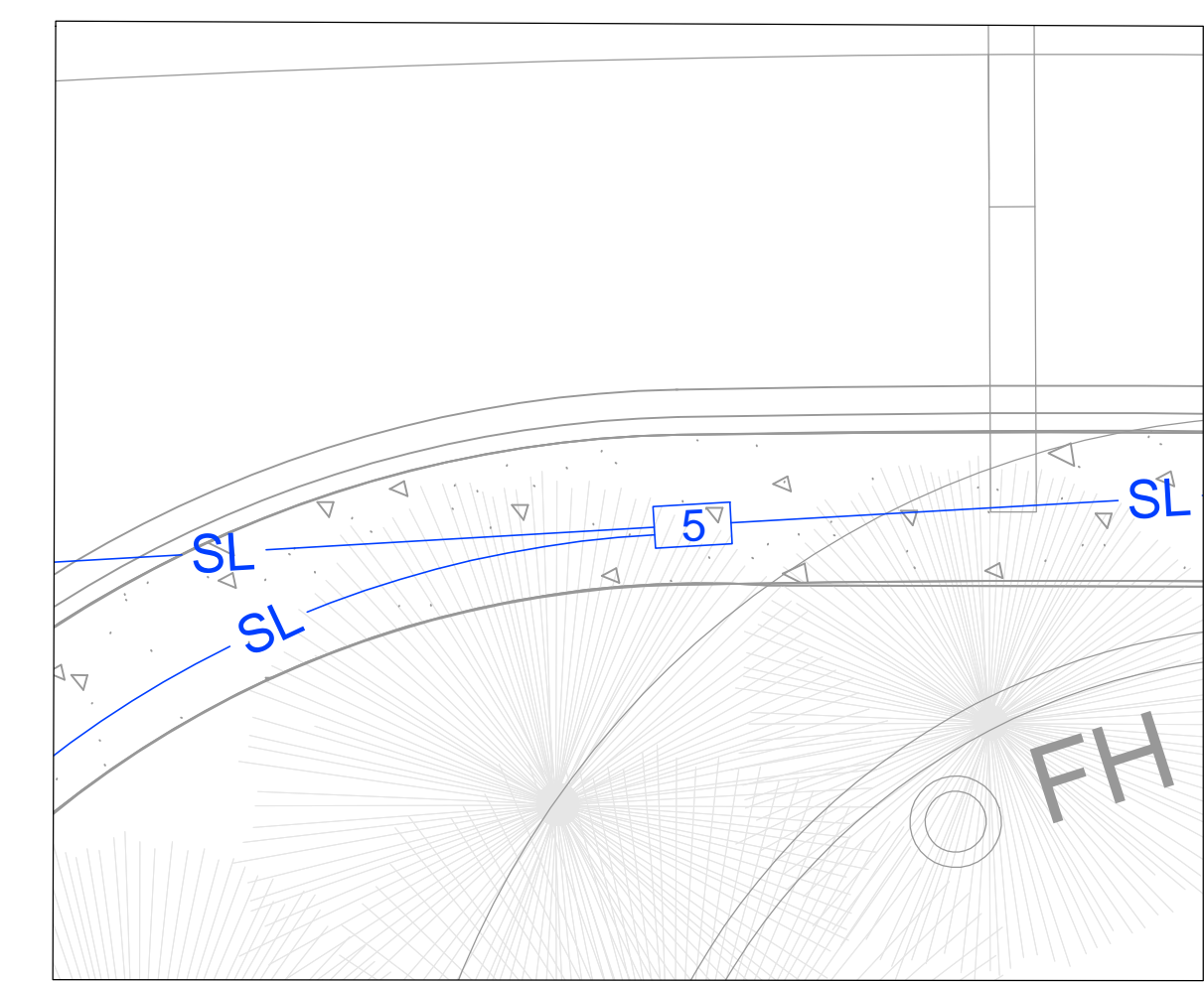

1 JB DETAIL
1 N.T.S.

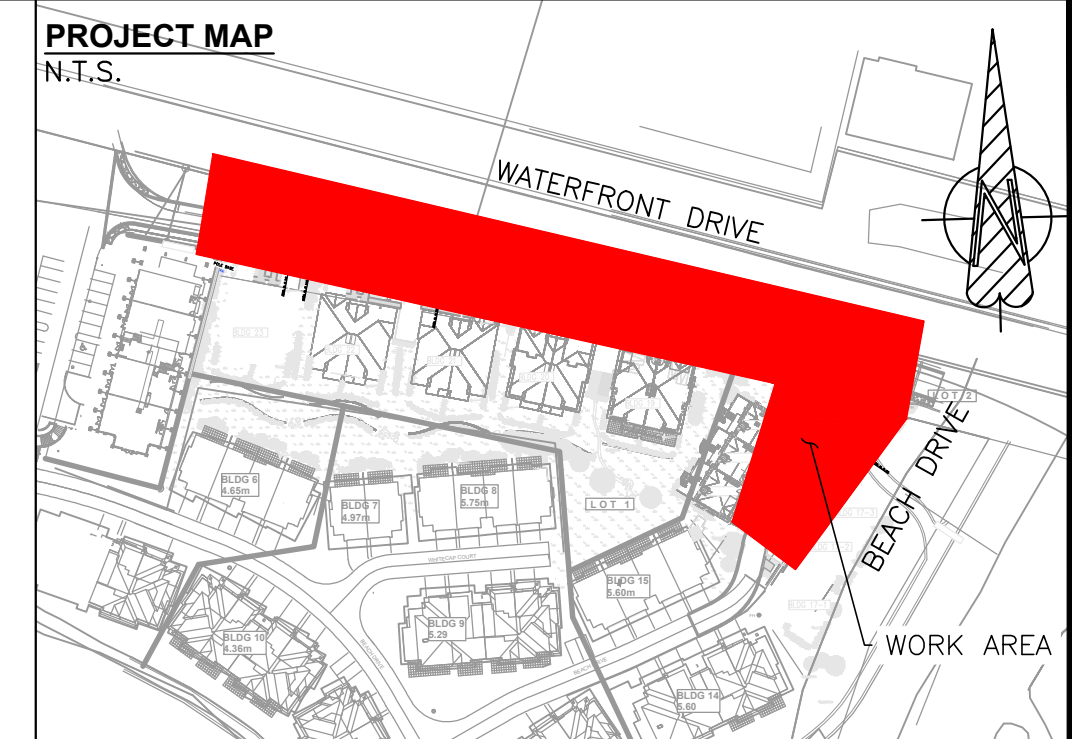

- CIVIL CONSTRUCTION NOTES:**
- COMPLY WITH ALL GOVERNING REQUIREMENTS OF CEC, PART 1, 23RD EDITION, CAN/CSA - C22.3 #7-10 AND C22.2 #52-09, C22.2 #211.1-06, C22.2 #211.2 -06.
 - PERFORM DETAILED SITE INVESTIGATION PRIOR TO CONSTRUCTION. IF DISCOVERED THAT SITE CONDITIONS DO NOT ALLOW TO FOLLOW THE ORIGINAL DESIGN - ELECTRICAL DESIGN SHALL BE NOTIFIED IMMEDIATELY. ANY CHANGES TO THE ORIGINAL DESIGN SHALL BE REVIEWED AND APPROVED BY ELECTRICAL DESIGN.
 - PHOTO DOCUMENT ALL EQUIPMENT INSTALLATION BEFORE BACKFILLING AND SUBMIT TO ELECTRICAL DESIGN.
 - TEMPORARY SUPPORT, ADEQUATE PROTECTION, AND MAINTENANCE OF ALL UNDERGROUND AND SURFACE UTILITIES STRUCTURES, DRAINS, SEWERS, AND OTHER OBSTRUCTIONS ENCOUNTERED IN THE PROGRESS OF THE WORK SHALL BE PROVIDED BY ELECTRICAL OPS.
 - ALL JUNCTION BOXES SHALL BE CITY APPROVED, TIER 22 RATED, SIZE AS SPECIFIED ON DRAWING.
 - LOCATION OF EXISTING JUNCTION BOXES ARE DIAGRAMMATIC ONLY. ALL NEW JUNCTION BOXES SHALL BE LOCATED IN BOULEVARD AREAS (MAY BE ADJUSTED TO SUIT FIELD CONDITIONS IN CONSULTATION WITH ELECTRICAL DESIGN). ALL CHANGES SHALL BE RECORDED ON AS-BUILT DRAWINGS.
 - INSTALLATION OF JUNCTION BOXES TO BE AS PER MANUFACTURER'S INSTALLATION MANUAL.
 - ALL OFFSETS INDICATE CENTERLINE OF COV DUCTS BANK.
 - ROUTING OF EXISTING CONDUIT(S) IS DIAGRAMMATIC ONLY, OTHERWISE AS NOTED. ROUTING OF PROPOSED CONDUIT (S) MAY BE ADJUSTED TO SUIT FIELD CONDITIONS IN CONSULTATION WITH ELECTRICAL DESIGN.
 - COV DUCT CLEARANCES TO OTHER UTILITIES SHALL BE AS PER COV UTILITIES DESIGN & CONSTRUCTION MANUAL. EXCEPTIONS WILL BE CONSIDERED BY ELECTRICAL DESIGN.
 - TOTAL NUMBER OF BENDS SHALL NOT EXCEED A COMPOSITE ANGLE OF 360 DEGREES. ALL CONDUIT BENDS SHALL BE FACTORY MADE ONLY, NO FIELD BENDS WILL BE ACCEPTED.
 - CONDUITS SHALL HAVE A MINIMUM OF 600 MM OF COVER AND INSTALLED AS PER SPECIFIED DUCT CONFIGURATION/TRENCH DETAILS.
 - AN APPROVED "BURIED CABLE" MARKER TAPE SHALL BE INSTALLED IN ALL TRENCHES.
 - CLEARANCE FROM TREE TRUNK SHALL BE AS SPECIFIED BY PARK OPS AND SHALL BE MINIMUM 305mm CLEARANCE FROM TREE TRUNK.
 - DUCT ENTERING TO JUNCTION BOX SHALL BE THRU OPEN BOTTOM EXCEPT FOR COMM JB & VAULT 243.
 - DUCT IN JUNCTION BOX SHALL BE C/W BELL END.
 - STUBBED-OFF DUCTS AND EMPTY DUCTS IN JUNCTION BOX SHALL BE CAPPED.
 - OTHER UTILITIES SHOWN ON DRAWING ARE FOR REFERENCE ONLY. PROVE LOCATION OF ALL UTILITIES IN THE WORK AREA BEFORE CONSTRUCTION. FOR CURRENT INFORMATION CONTACT BC ONE CALL.
 - ALL DISTURBED AREAS SHALL BE RESTORED TO THE CONDITIONS PRIOR TO GROUND DISTURBANCE.

LEGEND:

| | EXISTING | PROPOSED |
|--|----------------|----------------|
| TRAFFIC SIGNAL DUCT | TS | TS |
| STREET LIGHTING DUCT | SL | SL |
| COMMUNICATION DUCT | COMM | COMM |
| STUB-OUT | () | () |
| STREET LIGHTING POLE/SHAFT | () | () |
| ROADWAY LUMINAIRE WITH ARM | () | () |
| PEDESTRIAN LUMINAIRE WITH ARM | () | () |
| ROADWAY LUMINAIRE | () | () |
| PEDESTRIAN LUMINAIRE | () | () |
| STREET LIGHTING POLE BLOCK NUMBER | 1 50 | 1 50 |
| JUNCTION BOX TYPE#3 JB (0.279x0.467m) | JB3 | JB3 |
| JUNCTION BOX TYPE#4 JB (0.330 x 0.610m) | JB4 | JB4 |
| JUNCTION BOX TYPE#5 JB (0.432 x 0.762m) | JB5 | JB5 |
| JUNCTION BOX TYPE #6 JB (0.609 x 0.914m) | JB6 | JB6 |
| JUNCTION BOX (COMM) TYPE #62 JB (0.609x0.914x1.219m) | COMM 62 | COMM 62 |
| COMMUNICATION VAULT | COMM VAULT 243 | COMM VAULT 243 |
| EXISTING DEVICE (JB) TO BE REMOVED | 6 | 6 |
| ELECTRICAL PANEL | () | () |
| LED PEDESTRIAN (4.3m-LED) ON A TYPE B-CONCRETE BASE. | () | () |
| 2'x4'x3' PAD MOUNTED KIOSK/CABINET | () | () |
| ELECTRICAL SCOPE OF WORK | () | () |
| CIVIL SCOPE OF WORK | () | () |
| SCOPE OF WORK NOTE | () | () |

| REV. | NO. | DATE | DESCRIPTION | DRAWN | DESIGN | ENG. CHECK | REFERENCE DRAWINGS |
|------|-------------|-------------------|-------------|-------|--------|------------|--------------------|
| A | 2024-SEP-10 | ISSUED FOR REVIEW | | KZ | MV | MV | |

NEMETZ (S/A) & ASSOCIATES LTD.
ELECTRICAL CONSULTING ENGINEERS
2009 WEST 4TH AVENUE, VANCOUVER, B.C. CANADA V6J 4K3
TEL: (604) 736-6562 FAX: (604) 736-9800
E-MAIL: ENGINEERS@NEMETZ.COM

Copyright reserved. This plan and design is to all times remain the exclusive property of NEMETZ (S/A) & ASSOCIATES LTD. and cannot be used in whole or in part without the engineer's written consent.

ELECTRICAL ENGINEER SEAL
TRAFFIC ENGINEER SEAL

ATTENTION
UNITS SHOWN ON THIS PLAN ARE IN METRES

CSA S250 ACCURACY NAD85-10UTM
BASE ACCURACY LEVEL: 4+/-1000MM
ASB ACCURACY LEVEL: 4+/-1000MM

NEMETZ (S/A) & ASSOCIATES
STREET LIGHTING DESIGN
CIVIL DESIGN
OLIVER'S LANDING AT FURRY CREEK FINE PEACE

PROJECT NUMBER: 15330
SCALE: AS NOTED
SHEET: 2 OF 3
REV: 0